

Nitrate Groundwater Contamination from an Elementary School - A Case Study

Tricia Angoli
On-Site Wastewater Section
NCDENR



Gray's Creek Elementary

- ∞ **Located in Cumberland County**
- ∞ **950 Student Elementary School**
- ∞ **Cafeteria, no gymnasium**
- ∞ **Treatment system designed for 11,400 gpd**
- ∞ **Drainfield designed for 8,550 gpd**



Treatment and Disposal System

- ∩ **2 Grease Traps - total capacity 7,000 gallons**
- ∩ **12,000 gallon septic tank**
- ∩ **14,000 gallon equalization tank**
- ∩ **Three cell recirculating sand filter**
- ∩ **8,000 gallon final pump tank**
- ∩ **8,000 linear feet drainlines divided into four fields (pressure manifold)**

DWQ Review

Ω DWQ Groundwater Section reviewed the plans and made the following comments:

- Computer modeling did not show that mounding beneath the drainfields would be a concern
- House located approximately 500 to the north of the drainfields - determine if on water supply well, if so, well should be abandoned or monitoring well installed half way between the water supply well and drainfield

DWQ Review (cont)

- Ω DWQ Groundwater Section reviewed the plans and made the following comments:
- Subdivision with water supply wells located 400 to 500 feet east of Nitrification Field No. 4, monitoring well should be located between Field No. 4 and subdivision and upgradient of drainfield

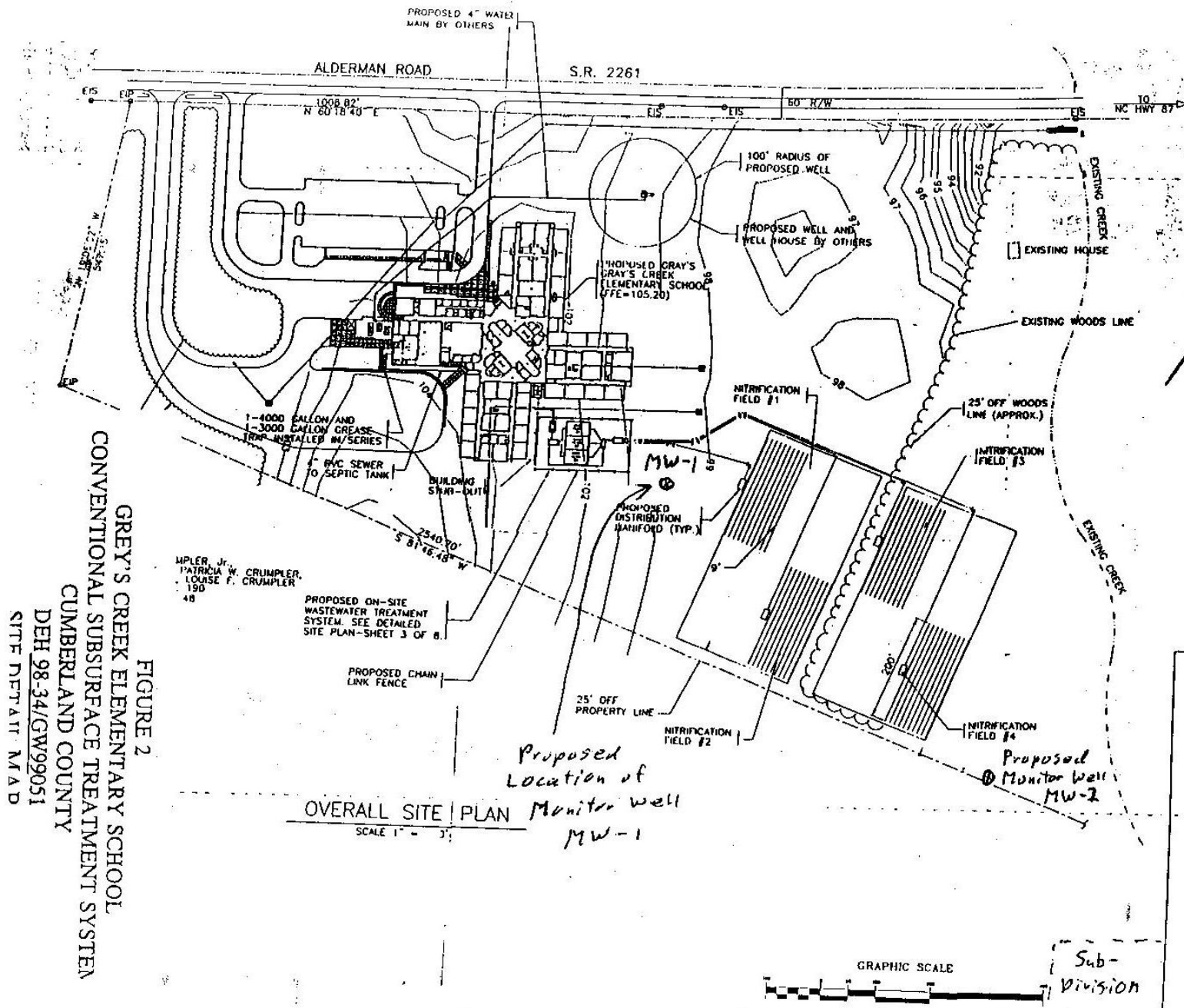

LEGEND

- EXISTING CREEK
- PROPOSED SEWER
- EXISTING BUILDING
- EXISTING DITCH
- EXISTING PROPERTY
- PROPOSED FENCE
- EXISTING FENCE
- EXISTING TREE LINE
- EXISTING DRAINAGE
- ⊙ EXISTING POWER P
- EXISTING TREE
- ⊕ EXISTING SHRUBS
- ⊠ EXISTING CATCH BAS

FIGURE 2

GREY'S CREEK ELEMENTARY SCHOOL
 CONVENTIONAL SUBSURFACE TREATMENT SYSTEM
 CUMBERLAND COUNTY

DEH 98-34/GW99051
 SITE DETAIL M.A.D.



Ω System went on-line in 2001



Ω Spring 2003, the operator called the Section to let them know that one of the groundwater monitoring wells was coming up “hot”

Notice of Groundwater Standards Exceedance

Ω **Issued June 19, 2003**

Ω **Monitoring well #2**

- **Nitrate - 33.4 mg/l - 4/15/03**
- **Nitrate - 61.2 mg/l - 6/2/03**
- **Nitrate - 37.26 mg/l - 6/16/03**

Ω **Samples were taken at some of the wells**

Ω **Sand filter effluent samples taken**

- **Nitrate - 84.4 mg/l - 5/12/03**

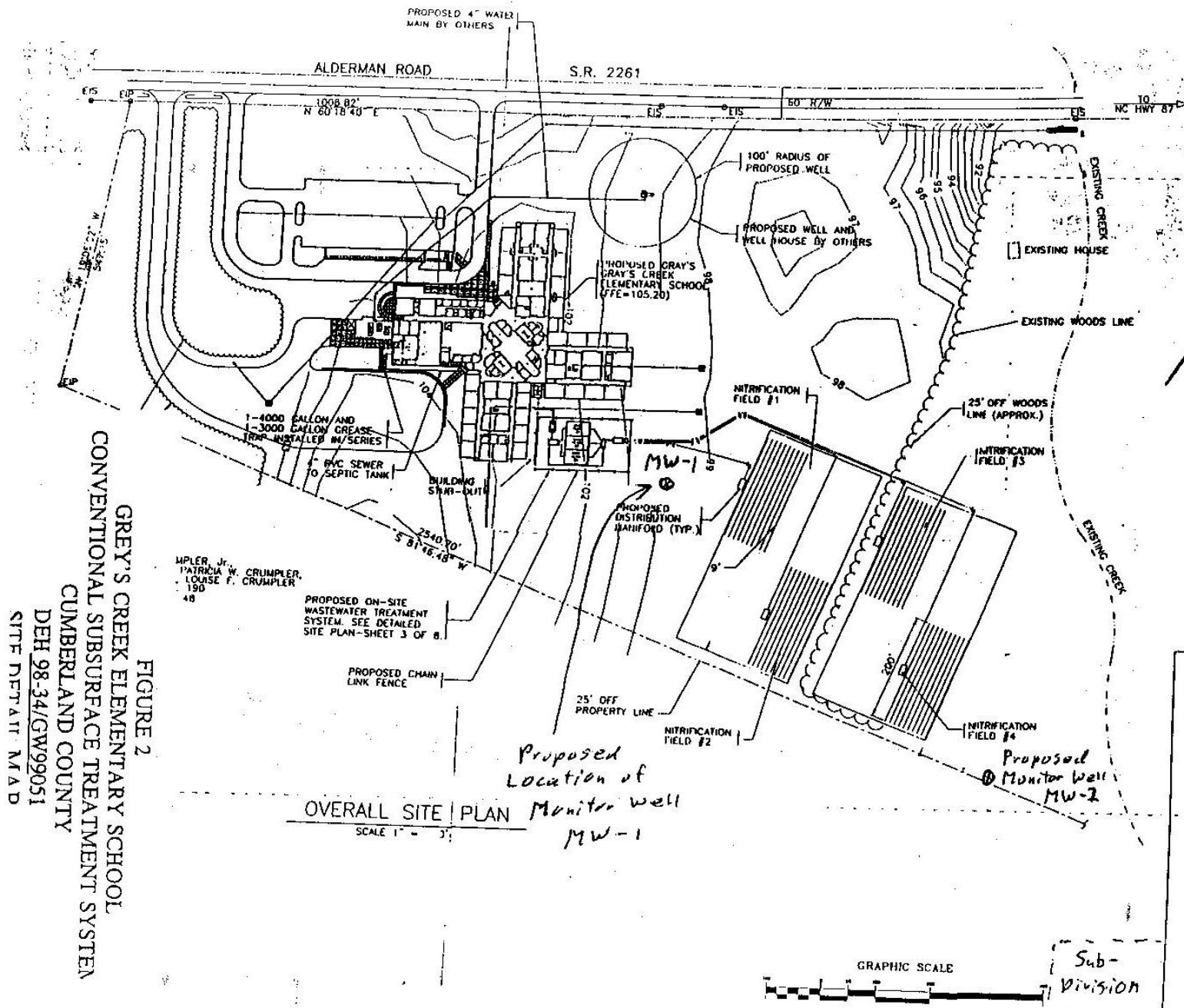

LEGEND

- EXISTING CREEK
- PROPOSED SEWER
- EXISTING BUILDING
- EXISTING DITCH
- EXISTING PROPERTY
- PROPOSED FENCE
- EXISTING FENCE
- EXISTING TREE LINE
- EXISTING DRAINAGE
- EXISTING POWER P
- EXISTING TREE
- EXISTING SHRUBS
- EXISTING CATCH BAS

FIGURE 2

GREY'S CREEK ELEMENTARY SCHOOL
 CONVENTIONAL SUBSURFACE TREATMENT SYSTEM
 CUMBERLAND COUNTY

DEH 98-34/GW99051
 SITE DETAIL M.A.D.



Suggested Actions by the Section or Health Department

- Ω Modify the permit to require a groundwater Comprehensive Site Assessment report**
- Ω Suspend the operation permit**
- Ω Require pump and haul until the system has been repaired**

Actions Taken by School BOE

- Ω Hired Environmental Hydrogeological Consultants, Inc to conduct the Comprehensive Site Assessment report**
- Ω Requested Bob Deweese with DPI to revise the plans for the existing sand filter and drainfields**

Results of Comprehensive Site Assessment Report

- ⌚ **Groundwater flow direction appears to be nearly due east, toward southeastern corner of property**
- ⌚ **High concentrations of Nitrate-N are down gradient from the wastewater distribution field in the estimated direction of groundwater flow**

3. OWNER: Cumberland Co. School System
 Address 810 Gillespie St
 (Street or Route No.)
Fayetteville NC 28306
 City or Town State Zip Code
(910)-678-2651
 Area code- Phone number

4. DATE DRILLED 30 JUN 03
 5. TOTAL DEPTH: 23-FT
 6. DOES WELL REPLACE EXISTING WELL? YES NO
 7. STATIC WATER LEVEL Below Top of Casing: 16 FT.
 (Use "+" if Above Top of Casing)
 8. TOP OF CASING IS 2.5 FT. Above Land Surface*
 *Top of casing terminated at/or below land surface requires a variance in accordance with 15A NCAC 2C .0118.
 9. YIELD (gpm): > 1gpm METHOD OF TEST bailey
 10. WATER ZONES (depth):

11. DISINFECTION: Type none Amount _____
 12. CASING: Wall Thickness _____

From	Depth	To	Diameter	or Weight/Ft.	Material
From <u>2.5'</u>	Depth <u>13'</u>	To <u>13'</u>	Diameter <u>2-in</u>	or Weight/Ft. <u>Sch 40</u>	Material <u>PVC</u>
From _____	Depth _____	To _____	Diameter _____	or Weight/Ft. _____	Material _____
From _____	Depth _____	To _____	Diameter _____	or Weight/Ft. _____	Material _____

13. GROUT: Method _____

From	Depth	To	Material	Method
From <u>surf</u>	Depth <u>6</u>	To <u>6</u>	Material <u>Portland No 1</u>	Method <u>Pour</u>
From <u>6</u>	Depth <u>11</u>	To <u>11</u>	Material <u>Bentonite Pellets</u>	Method <u>Pour</u>

14. SCREEN: Material _____

From	Depth	To	Diameter	Slot Size	Material
From <u>13'</u>	Depth <u>23'</u>	To <u>23'</u>	Diameter <u>2-in</u>	Slot Size <u>0.010 in.</u>	Material <u>PVC</u>
From _____	Depth _____	To _____	Diameter _____	Slot Size _____	Material _____

15. SAND/GRAVEL PACK: Material _____

From	Depth	To	Size	Material
From <u>11'</u>	Depth <u>23'</u>	To <u>23'</u>	Size <u>Med</u>	Material <u>Qtz Sand</u>
From _____	Depth _____	To _____	Size _____	Material _____

16. REMARKS: _____
 I DO HEREBY CERTIFY THAT THIS WELL WAS CONSTRUCTED IN ACCORDANCE WITH 15A NCAC 2C, WELL CONSTRUCTION STANDARDS, AND THAT A COPY OF THIS RECORD HAS BEEN PROVIDED TO THE WELL OWNER
Kenneth Brown 22 JUL 03
 SIGNATURE OF PERSON CONSTRUCTING THE WELL DATE

Latitude/longitude of well location
N34° 53' 43.5" x W78° 51' 24.7"
 (degrees/minutes/seconds)
 Latitude/longitude source: GPS Topographic map
 (check box) computer program
 DEPTH DRILLING LOG

From	To	Formation Description
0'	3'	Brown Clay/Silt/fine sand
3'	2'	lt Tan/yellow mottled
		fn sandy SILT/CLAY
9'	17'	lt Tan/yellow mottled
		fn-MD-CSE SAND
		(variable text.)
17'	23'	white fn-MD SAND.
		23' Boring terminated

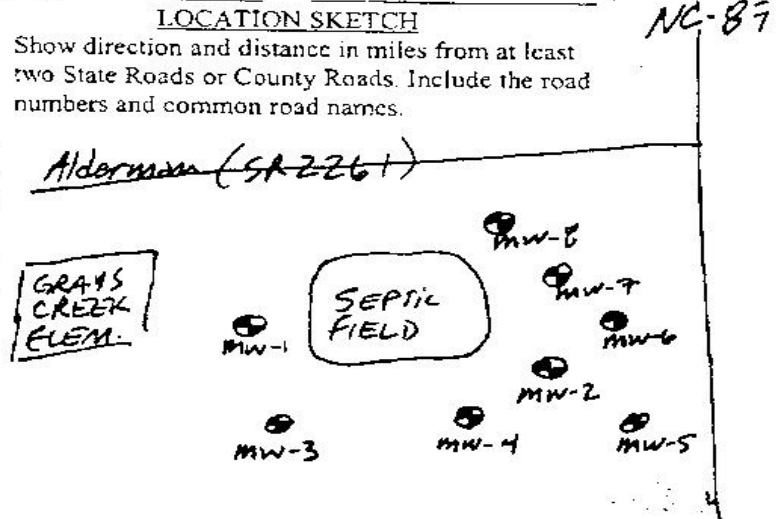

Submit the original to the Division of Water Quality, Groundwater Section, 1636 Mail Service Center - Raleigh, NC
 27699-1636 Phone No. (919) 733-3221, within 30 days. GW-1 REV. 07/2001

Modifications to Recirculating Sand Filter

- ∞ **Increasing storage in the underdrain collection system**
- ∞ **Increase storage in the recirculation tank**
- ∞ **Add a new recirculation line from the sand filter dosing pump to the effluent end of the septic tank**
- ∞ **Results - no significant reduction in nitrate in sand filter effluent**



Next Step

- Ω **Find a new location for the drainfields**
- Ω **Use a low pressure pipe distribution method for the new drainfields**

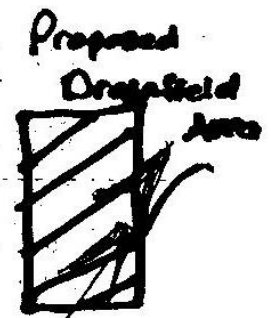
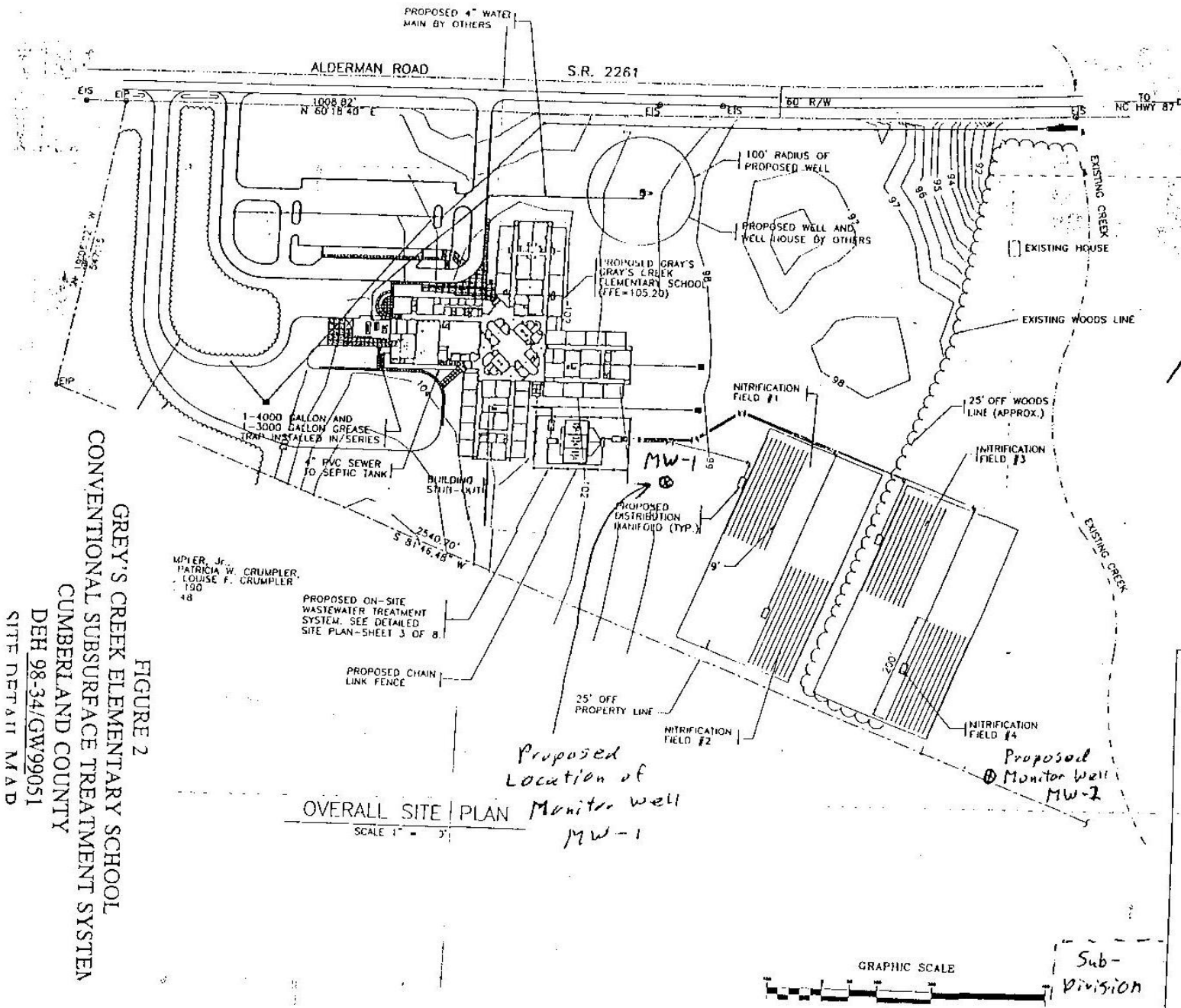

LEGEND	
	EXISTING CREEK
	PROPOSED SEWER
	EXISTING BUILDING
	EXISTING DITCH
	EXISTING PROPERTY LINE
	PROPOSED FENCE
	EXISTING FENCE
	EXISTING TREE LINE
	EXISTING DRAINAGE
	EXISTING POWER POLE
	EXISTING TREE
	EXISTING SHRUBS
	EXISTING CATCH BASIN

FIGURE 2

GREY'S CREEK ELEMENTARY SCHOOL

CONVENTIONAL SUBSURFACE TREATMENT SYSTEM

CUMBERLAND COUNTY

DEH 98-34/GW99051

SITE DEPT. I M.A.D.

Current System Performance

- Ω **System was installed in Summer 2005**
- Ω **Had to rebuild existing sand filters**
 - **wrong size sand**
 - **only 4 inches of gravel in bottom of filter**
- Ω **Just started recirculating effluent through sand filters middle of October**
- Ω **First sampling in November**

Lessons Learned

- ⌚ **Everything was done correctly during review: pretreatment, groundwater mounding analysis, etc**
- ⌚ **Pretreatment doesn't always work as well as anticipated**
- ⌚ **Pressure distribution of effluent (not with a pressure manifold) should be considered for large systems**